

**YELLOWSTONE COUNTY BOARD OF COUNTY COMMISSIONERS**

Resolution No. 22-87

**Resolution to Create Yellowstone County Rural Special Improvement District No. 880M  
for the Maintenance of the Dry Hydrant within Brey Subdivision**

WHEREAS, pursuant to Sections 7-12-2101 through 7-12-2113 of the Montana Code Annotated, a board of county commissioners has the authority to create a rural special improvement district to develop and maintain a dry hydrant. To create a district, a board should pass a resolution of intent, set a public hearing, provide notice of the public hearing, receive protests, hold a public hearing, consider protests and pass a resolution that either creates or does not create the district.

WHEREAS, the Yellowstone County Board of County Commissioners intend to create a rural special improvement district to maintain the dry hydrant within Brey Subdivision. Currently, there is no mechanism to finance the maintenance of the dry hydrant within the Subdivision. Below is a summary of the specifics of the District.

District Name:	Yellowstone County Rural Special Improvement District No. 880M
District Location:	Brey Subdivision. See Exhibit A.
District Parcels:	31 parcels. See Exhibit B.
District Activities:	Maintenance of Dry Hydrant
District Assessment:	\$25 Annually Per Parcel
District Duration:	Perpetual

WHEREAS, on August 30, 2022, the Yellowstone County Board of County Commissioners passed a resolution of intent to create Rural Special Improvement District No. 880M to maintain the dry hydrant in Brey Subdivision and set a public hearing on the creation of the District for October 4, 2022. On September 2, 2022, the Yellowstone County Clerk and Recorder mailed notice of the hearing to all property owners in the District. On September 2, 2022 and September 9, 2022, the Yellowstone County Clerk and Recorder published notice of the public hearings in the *Yellowstone County News*. On October 4, 2022, the Board held a public hearing on the creation of the District. The Board heard comments on the district and considered protests as to the creation of the District. The Board did not receive enough protests to prevent the formation of the District. Zero out of 31 property owners protested the creation of the District. The Board believes that it is in the best interest of the public to create the District.

NOW THEREFORE, BE IT RESOLVED,

The Yellowstone County Board of County Commissioners creates Rural Special Improvement District No. 880M to maintain the dry hydrant in Brey Subdivision. The specifics of the District are contained in the exhibits attached to this Resolution. Depending on the circumstance of the District, the Board may increase or decrease the assessment for the District.

Passed and Adopted on the 4<sup>th</sup> day of October 2022.

**BOARD OF COUNTY COMMISSIONERS YELLOWSTONE COUNTY, MONTANA**

  
Donald Jones Chairman

  
John Ostlund, Member

  
Denis Pitman, Member

Attest:

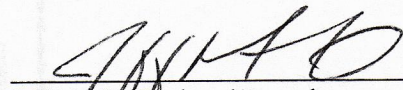
  
Jeff Martin, Clerk and Recorder

# EXHIBIT A

## Proposed New Dry Hydrant RSID for Brey Sub

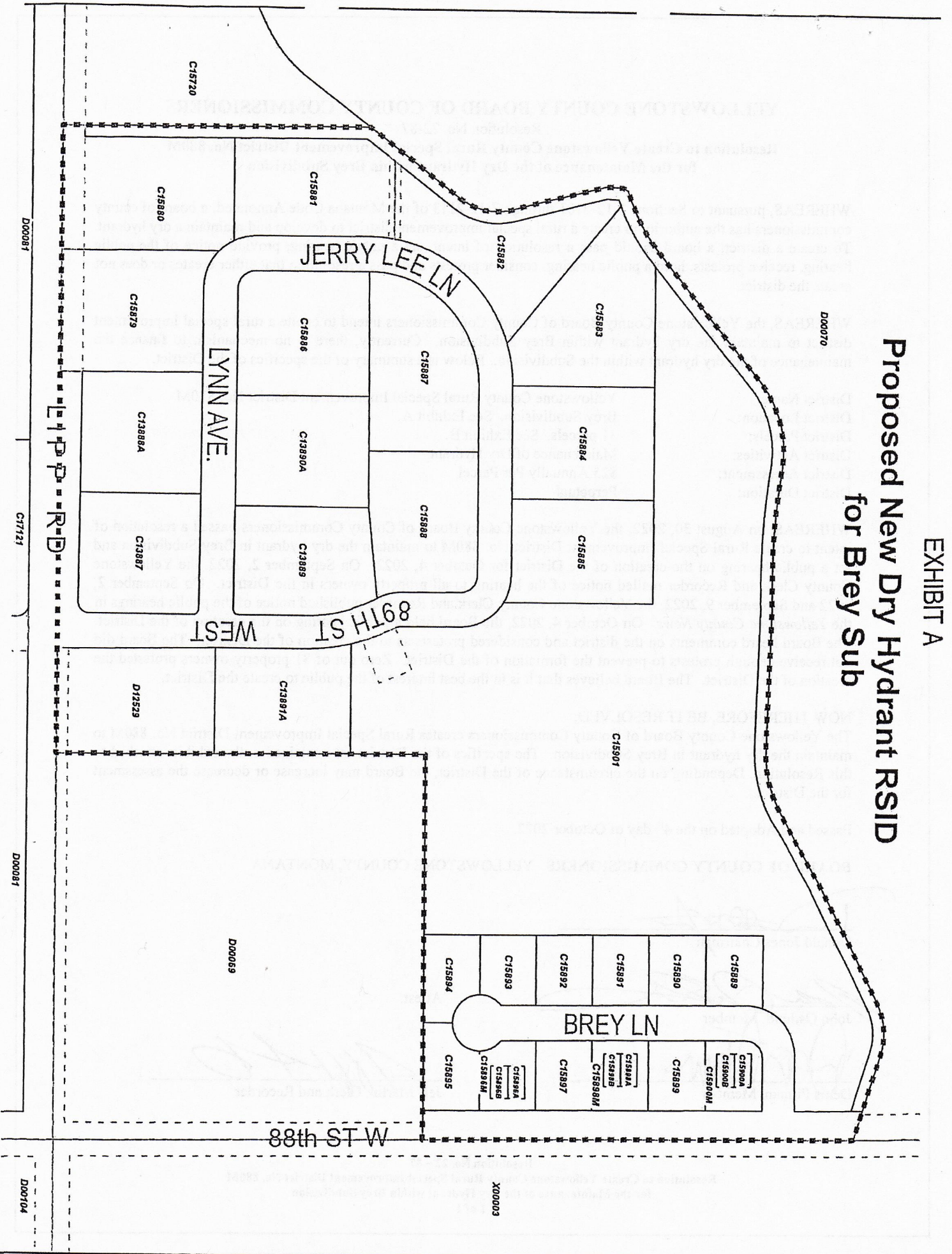

Tax ID	Owner Name	Mailing Address	City	ST	Zip	Legal Description
1	MAHON, MARTHA L & GARRY E	8930 LYNN AVE	BILLINGS	MT	59106-4609	BREY SUBD 1ST, S03, T01 S, R24 E, BLOCK 1, Lot 1, ACRES 1.029, 2009 REDMAN SN: 8028 TAXED W/REAL (04)
2	BUKSCON, STEVEN	8930 LYNN AVE	BILLINGS	MT	59106-4609	BREY SUBD 1ST, S03, T01 S, R24 E, BLOCK 1, Lot 2, ACRES 1.032
3	JOHNSON, TROY A & GAIL E	895 89TH ST W	BILLINGS	MT	59106-4620	BREY SUBD 1ST, S03, T01 S, R24 E, BLOCK 2, Lot 1, ACRES 1.015, 2003 FLEETWOOD TITLE: G204149 TAX W/REAL (03)
4	BRONKHILL, KALEB	895 89TH ST W	BILLINGS	MT	59106-4620	BREY SUBD 1ST, S03, T01 S, R24 E, BLOCK 2, Lot 2, ACRES 1.001, 1995 WICK EQUINE TITLE: W990449 (Identified) TAX W/REAL
5	GERMAN, ANIS MARIE	149 89TH ST W	BILLINGS	MT	59106-4620	BREY SUBD 1ST, S03, T01 S, R24 E, BLOCK 2, Lot 1, ACRES 1.005, 1998 NASHUA CASTLEWOOD TITLE: F863884 (Identified) TAXED W/REAL
6	SHERMAGH K	8970 LYNN AVE	BILLINGS	MT	59106-4609	BREY SUB 2ND FILING (08), S03, T01 S, R24 E, BLOCK 1, Lot 1, (08) 1.287 AC 2011 TRADITION TITLE: A00928211 SN: WY133075ABY TAXED R/REAL
7	SCHULTZ, KURT	9000 LYNN AVE	BILLINGS	MT	59106-4632	BREY SUB 2ND FILING (08), S03, T01 S, R24 E, BLOCK 1, Lot 4, 1.410 AC
8	MARTINEZ, FORTINO	8989 JERRY LEE LN	BILLINGS	MT	59106-4632	BREY SUB 2ND FILING (08), S03, T01 S, R24 E, BLOCK 1, Lot 5, 1.046 AC
9	WIDDICOMBE, LARRY	8977 JERRY LEE LN	BILLINGS	MT	59106-4632	BREY SUB 2ND FILING (08), S03, T01 S, R24 E, BLOCK 1, Lot 6, (08) 1.067 AC
10	GILG, CHARLES L & KANDY K	8959 JERRY LEE LN	BILLINGS	MT	59106-4632	BREY SUB 2ND FILING (08), S03, T01 S, R24 E, BLOCK 1, Lot 7, (08) 1.239 AC 2016 SCHULT TITLE: AA3164049 (Identified) ATTACHED TO REAL
11	AGUILAN, JESSE	8951 JERRY LEE LN	BILLINGS	MT	59106-4632	BREY SUB 2ND FILING (08), S03, T01 S, R24 E, BLOCK 1, Lot 8, (08) 1.131 AC 2017 SCHULT PATRIOT TITLE: AA4636410 (Identified) TAXED W/REAL
12	KOTIAN, PATRICK J & DEBORAH J	8935 JERRY LEE LN	BILLINGS	MT	59106-4632	BREY SUB 2ND FILING (08), S03, T01 S, R24 E, BLOCK 1, Lot 9, (08) 1.049 AC
13	WETMORE, KETH S	8955 LYNN AVE	BILLINGS	MT	59106-4619	BREY SUB 2ND FILING (08), S03, T01 S, R24 E, BLOCK 2, Lot 3, ACRES 1.13, 2010 FRIENDSHIP SN: 32584 ATTACHED TO REAL
14	CULP, CATHY	PO BOX 372	LAUREL	MT	59044-0372	BREY SUB 2ND FILING (08), S03, T01 S, R24 E, BLOCK 2, Lot 4, (08) 1.190 AC
15	SCHINER, JOSHUA & MACKENZIE	166 89TH ST W	BILLINGS	MT	59106-4620	BREY SUB 2ND FILING (08), S03, T01 S, R24 E, BLOCK 2, Lot 5, ACRES 1.052, (08) 2009 FRIENDSHIP 28X40 TITLE: UNKNOWN SN: 31839 TAXED W/REAL
16	JOHNSON, NEAL C & SALLY D	5835 ROWWOOD DR	BILLINGS	MT	59106-4620	BREY SUB 2ND FILING (08), S03, T01 S, R24 E, BLOCK 4, Lot 1, (09) 0.277 AC
17	NERSON, THOMAS R	2777 HOOVER AVE	BILLINGS	MT	59102-1606	BREY SUB 2ND FILING (08), S03, T01 S, R24 E, BLOCK 4, Lot 2, (09) 0.275 AC
18	OHNING, JOHN C, DIANNE BRIAN &	2495 WIKKI PL	BILLINGS	MT	59102-2037	BREY SUB 2ND FILING (08), S03, T01 S, R24 E, BLOCK 4, Lot 3, (09) 0.275 AC
19	POPP, GREGORY A & SHELLY	2706 TREASURE DR	BILLINGS	MT	59102-2145	BREY SUB 2ND FILING (08), S03, T01 S, R24 E, BLOCK 4, Lot 4, (08) 0.275 AC
20	BRUNS, CALVIN & JANICE	4910 BLUE SPRUCE CIR	BILLINGS	MT	59108-3300	BREY SUB 2ND FILING (08), S03, T01 S, R24 E, BLOCK 4, Lot 5, (08) 0.267 AC
21	EVERETT, STEVEN V	1612 HOLLYHOCK ST	BILLINGS	MT	59106-1575	BREY SUB 2ND FILING (08), S03, T01 S, R24 E, BLOCK 4, Lot 5, (08) 0.303 AC
22	SMITH, RONALD L & SANDRA F	2624 ASPEN WAY	BILLINGS	MT	59106-2209	215 BREY LANE (16), S03, T01 S, R24 E, UNIT 6, 50% COMMON AREA INTEREST, LOC @ LT 8 BLK 4 BREY SUB 2ND FIL
23	RAND, GERALD R & JULIE K	3072 WESTERN BLUFFS BLVD	LEHI	UT	84043-2740	215 BREY LANE (16), S03, T01 S, R24 E, UNIT 6, 50% COMMON AREA INTEREST, LOC @ LT 8 BLK 4 BREY SUB 2ND FIL
24	BATEMAN, DAVID	4203 N RED MARLE CT	BILLINGS	MT	59103-2905	BREY SUB 2ND FILING (08), S03, T01 S, R24 E, BLOCK 4, Lot 9, 0.275 AC
25	BECKORD JR, JAMES E	637 BAZZAN EXCHANGE	BILLINGS	MT	59102-4032	275 BREY LANE (16), S03, T01 S, R24 E, UNIT 4, 50% COMMON AREA INTEREST, LOC @ LT 10 BLK 4 BREY SUB 2ND FIL
26	DEQUAS LLC	3401 WINDMILL CIR	BILLINGS	MT	59106-4610	BREY SUB 2ND FILING (08), S03, T01 S, R24 E, BLOCK 4, Lot 11, 0.275 AC
27	KESSLER, CHARLES	1210 BERNINGER WAY	BILLINGS	MT	59106-4228	TWELVE STORAGE (14), S03, T01 S, R24 E, UNIT 8, 50% COMMON AREA INTEREST, LOC @ LT 12 BLK 4 BREY SUB 2ND FILING
28	TRUDE, DOUGLAS & JEANETTE R	2622 BROADWATER AVE	MANDAN	ND	58554-0228	TWELVE STORAGE (14), S03, T01 S, R24 E, UNIT 8, 50% COMMON AREA INTEREST, LOC @ LT 12 BLK 4 BREY SUB 2ND FILING
29	LEE, CLAYTON & LISA	PO BOX 238	MANDAN	ND	58554-0228	TWELVE STORAGE (14), S03, T01 S, R24 E, UNIT 8, 50% COMMON AREA INTEREST, LOC @ LT 12 BLK 4 BREY SUB 2ND FILING
30	LEE, CLAYTON & LISA	PO BOX 238	MANDAN	ND	58554-0228	TWELVE STORAGE (14), S03, T01 S, R24 E, UNIT 8, 50% COMMON AREA INTEREST, LOC @ LT 12 BLK 4 BREY SUB 2ND FILING
31	ADAMS, ROBERT S	8905 LIPP RD	BILLINGS	MT	59106-4608	S03, T01 S, R24 E, C.O.S., 3010, PARCEL 3, 1.209 AC (2000) 1998 VICTORIAN TITLE: E433368 (02) ATTACHED TO REAL

Exhibit B